

*"Friend of the Plumber"®*

# Replacement Parts



*Order by Phone: 800-438-5327*

*Order by fax: 828-247-6609*

[www.plasticoddities.com](http://www.plasticoddities.com)

### Stainless Steel Stamped Strainer



- Easy installation

PART #	SIZE	DESCRIPTION	A
SP23	3.5"	Stainless Steel	3.5"
SP24	4.5"	Stainless Steel	4.5"

### Stainless Steel Stamped Access Cover

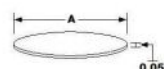

- Easy installation

PART #	SIZE	DESCRIPTION	A
SP230	3.5"	Stainless Steel	3.5"
SP240	4.5"	Stainless Steel	4.5"

### 4" Stamped Strainer

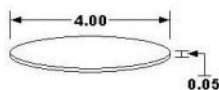

- Easy installation

PART #	SIZE	DESCRIPTION
SP1	4"	Stainless Steel
SP1SAB	4"	Antique Gold Stainless Steel
SP1SPB	4"	Polished Gold Stainless Steel

### Cast Strainer



- Easy installation
- Each size available in brass and nickel

PART #	SIZE	DESCRIPTION	A	B
SP2AB	4"	Antique Brass Cast Strainer	4"	0.12"
SP2PB	4"	Polished Brass Cast Strainer	4"	0.12"
SP2N	4"	Nickel Cast Strainer	4"	0.12"
SP4AB	4 - 3/4"	Antique Brass Cast Strainer	4.85"	0.15"
SP4PB	4 - 3/4"	Polished Brass Cast Strainer	4.85"	0.15"
SP4N	4 - 3/4"	Nickel Cast Strainer	4.85"	0.15"
SP8AB	6"	Antique Brass Cast Strainer	5.4"	0.18"
SP8PB	6"	Polished Brass Cast Strainer	5.4"	0.18"
SP8N	6"	Nickel Cast Strainer	5.4"	0.18"

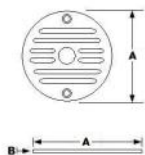

### 4 - 1/4" Stamped Strainer

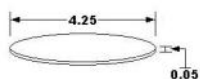

- Easy installation

PART #	SIZE	DESCRIPTION
SP12	4 - 1/4"	Stainless Steel
SP12SAB	4 - 1/4"	Antique Gold Stainless Steel
SP12SPB	4 - 1/4"	Polished Gold Stainless Steel

### 4 - 1/4" Cast Strainer



- Easy installation
- Each size available in brass and nickel

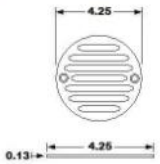

PART #	SIZE	DESCRIPTION
SP12AB	4 - 1/4"	Antique Brass Cast Strainer
SP12PB	4 - 1/4"	Polished Brass Cast Strainer
SP12N	4 - 1/4"	Nickel Cast Strainer

### Nickel 4-7/8" Cast Strainer With Sundial Pattern



- Easy installation

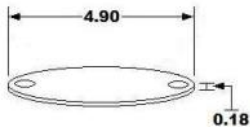

PART #	SIZE	DESCRIPTION
SP6N	4 - 7/8"	Polished Nickel

### Stainless Steel 4 - 7/8" Stamped Strainer



- Easy installation

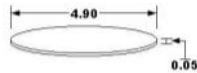

PART #	SIZE	DESCRIPTION
SP3	4 - 7/8"	Stainless Steel

### Metal Scoriated Cleanout Cover



- Easy installation

PART #	SIZE	DESCRIPTION	A	B
SP5BS	4"	Scoriated Brass	0.12"	3.9"
SP5N	4"	Scoriated Nickel	0.12"	3.9"
SP7BS	4 - 7/8"	Scoriated Brass	0.15"	4.8"
SP7N	4 - 7/8"	Scoriated Nickel	0.15"	4.8"
SP9BS	5.5"	Scoriated Brass	0.2"	5.4"
SP9N	5.5"	Scoriated Nickel	0.2"	5.4"

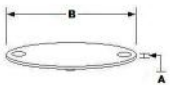

### Gold PVC 5.5" Sundial Strainer



- Easy installation

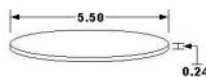

PART #	SIZE	DESCRIPTION
SP8P	5.5"	Gold PVC

### Gold PVC 5.5" Scoriated Cleanout Cover

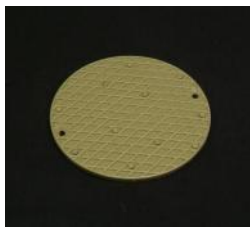

- Easy installation

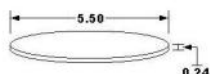

PART #	SIZE	DESCRIPTION
SP9P	5.5"	Bronze Color Scoriated Plastic

### Round Ring



- Available in brass and nickel - 4", 5", and 6"

PART #	SIZE	DESCRIPTION	A	B	C	D
SP400PB	4"	Polished Brass 4" Round Ring	4.37"	4"	0.27"	0.25"
SP400N	4"	Nickel 4" Round Ring	4.37"	4"	0.27"	0.25"
SP500PB	5"	Polished Brass 5" Round Ring	5.22"	4.85"	0.45"	0.33"
SP500N	5"	Nickel 5" Round Ring	5.22"	4.85"	0.45"	0.33"
SP600PB	6"	Polished Brass 6" Round Ring	6"	5.45"	0.52"	0.35"
SP600N	6"	Nickel 6" Round Ring	6"	5.45"	0.52"	0.35"



### Square Ring



- Available in brass and nickel - 4", 5", and 6"

PART #	SIZE	DESCRIPTION	A	B	C	D
SQ400PB	4"	Polished Brass 5" x 5" Square Ring	4.37"	4"	0.35"	0.31"
SQ400N	4"	Nickel 5" x 5" Square Ring	4.37"	4"	0.35"	0.31"
SQ500PB	5"	Polished Brass 6" x 6" Square Ring	6"	4.85"	0.45"	0.33"
SQ500N	5"	Nickel 6" x 6" Square Ring	6"	4.85"	0.45"	0.33"
SQ700PB	6"	Polished Brass 7" x 7" Square Ring	7"	5.45"	0.52"	0.35"
SQ700N	6"	Nickel 7" x 7" Square Ring	7"	5.45"	0.52"	0.35"



### Polished Brass Cast Strainer



- Easy installation
- Each size available in brass and nickel

PART #	SIZE	DESCRIPTION	A
SP10B	7.5"	Polished Brass Cast Strainer	7.5"
SP10N	7.5"	Nickel Cast Strainer	7.5"
SP11B	9.5"	Polished Brass Cast Strainer	9.5"
SP11N	9.5"	Nickel Cast Strainer	9.5"

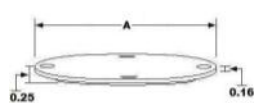

### PVC 5" Snap & Lok™ Strainer



- Plastic strainer for Snap & Lok™ series

PART#	DESCRIPTION
PSL560L	Snap & Lok strainer

### Shallow Sump Floor Sink Grate

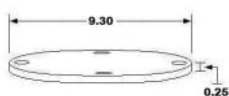

- Grate fits 2" x 3" and 3" x 4" shallow sump floor sinks
- Available in full, half, and three quarters grate pattern

PART#	SIZE	DESCRIPTION
SP11LFA	2x3 & 3x4	Aluminum Full Grate
SP11LFB	2x3 & 3x4	Bronze Full Grate
SP11LFN	2x3 & 3x4	Nickel Full Grate
SP11LHA	2x3 & 3x4	Aluminum Half Grate
SP11LHB	2x3 & 3x4	Bronze Half Grate
SP11LHN	2x3 & 3x4	Nickel Half Grate
SP11LTA	2x3 & 3x4	Aluminum 3/4 Grate
SP11LTB	2x3 & 3x4	Bronze 3/4 Grate
SP11LTN	2x3 & 3x4	Nickel 3/4 Grate

### Plastic 8.5" Drain Grate

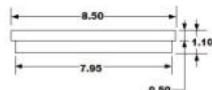

- Plastic 8.5" grate drain grate only

PART#	SIZE	DESCRIPTION
PSP54	8.5"	8.5" Diameter Grate

### 8.5" Metal Grate For Grate Floor Drains



- 8.5" grate for grate drain series
- Available in aluminum, brass, nickel, and cast iron

PART#	SIZE	DESCRIPTION
SP54A	8.5"	Aluminum 8.5" Grate Only
SP54B	8.5"	Brass 8.5" Grate Only
SP54N	8.5"	Nickel 8.5" Grate Only
SP54C	8.5"	Cast Iron 8.5" Grate Only

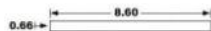

### 12" Diameter Round Plastic Floor Sink Grate

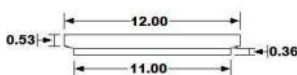

- 12" diameter grate, 54 square inch flow, 1" thick
- Grate is full and will fit any size deep sump floor sink
- Grate is also available in aluminum, brass and nickel

PART#	SIZE	DESCRIPTION
PDSG100	12" Diameter	Full Grate
PDSG75	12" Diameter	3/4 Grate
PDSG50	12" Diameter	1/2 Grate

## Metal Floor Sink Grate



- 12" Diameter grate for floor sink and deep sump utility drain
- Available in PVC, aluminum, brass, and nickel

**PART#    DIAMETER    DESCRIPTION**

SDSG100A	12"	Aluminum Drain
SDSG100B	12"	Bronze Drain
SDSG100N	12"	Nickel Drain

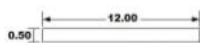

## Sediment Bucket For Grate Drain



- Optional sediment bucket for 3" or 4" grate drain

**PART #**

**PVC    SIZE    DESCRIPTION**

PSP52	3", 4"	Sediment Bucket
PSP52S	3", 4"	Solid Sediment Bucket

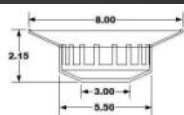

## 9" Grate Drain Collar

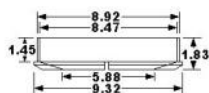

- Collar for grate drain series
- Available in cast brass and nickel

**PART#    SIZE    DESCRIPTION**

SP50B	9"	Brass 9" Grate Drain Collar Only
SP50N	9"	Nickel 9" Grate Drain Collar Only

## Aluminum Floor Sink Beehive Strainer

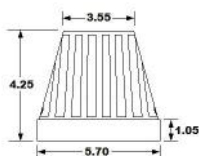

- Aluminum beehive strainer for 2", 3", and 4" floor sinks and deep sump utility drains

**PART#    DESCRIPTION**

SPB1A	Aluminum Strainer
-------	-------------------

## 8" Standard Roof Dome



- 8" roof dome fits 3", 4", and 6" pipe size roof drain
- Available in plastic, cast iron, aluminum, brass, and nickel

**PART#    DESCRIPTION**

SP61A	Aluminum Dome
SP61B	Brass Dome
SP61N	Nickel Dome
SP61C	Cast Iron Dome
SP61P	Plastic Dome

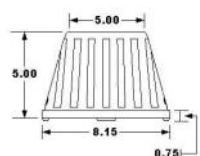



## 16" Diameter Roof Drain Receiver Drain



- 16" receiver pan converts basic roof drain to a wide flange, flat pan assembly

**PART#**    **SIZE**            **DESCRIPTION**

PRD16    16"    PVC Roof Drain Receiver Pan

ARD16    16"    ABS Roof Drain Receiver Pan

## Under Deck Clamp Kit For 6" Roof Drains

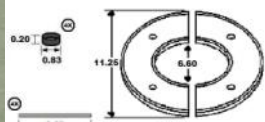

- Clamp kit for 6" roof drains

**PART#**                            **DESCRIPTION**

UDC996                            Clamp Kit for 6" Roof Drains

## Under Deck Clamp Kit For 3" & 4" Roof Drains

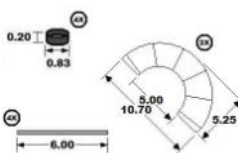

- Kit includes 2 piece black styrene clamp, 4 threaded studs, 4 bolts, and 4 washers

**PART#**                            **DESCRIPTION**

UDC990    Under Deck Clamp Kit

# Quick Reference Replacement Strainers List

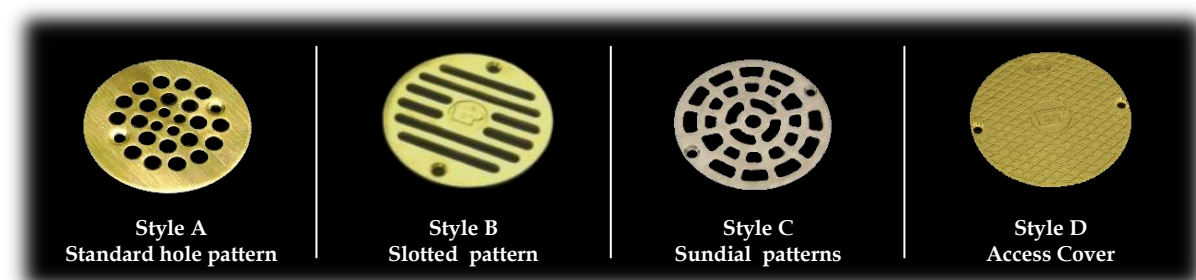

PART #	STYLE	DIAMETER	MATERIAL	# SCREW HOLES	SCREW MOUNT DIAMETER	THICKNESS
<b>3 1/2"</b>						
SP-23	A	3 1/2"	Stainless steel	2	2 3/8"	.035
SP-230	D	3 1/2"	Stainless steel	2	2 3/8"	.035
<b>4"</b>						
SP-1	A	4"	Stainless steel	2	3 3/8"	.035
SP-1spb	A	4"	Polished gold stainless steel	2	3 3/8"	.035
SP-1sab	A	4"	Antique gold stainless steel	2	3 3/8"	.035
SP-1375	A	4"	Bone white bonded stainless steel	2	3 3/8"	.035
SP-1376	A	4"	Black bonded stainless steel	2	3 3/8"	.035
SP-1377	A	4"	Gray bonded stainless steel	2	3 3/8"	.035
SP-1378	A	4"	Red bonded stainless steel	2	3 3/8"	.035
SP-2n	B	4"	Polished Nickeland™	2	3 3/8"	.075/.250
SP-2pb	B	4"	Polished brass	2	3 3/8"	.075/.250
SP-2ab	B	4"	Antique brass	2	3 3/8"	.075/.250
<b>4 1/4"</b>						
SP-12	A	4 1/4"	Stainless steel	2	2 5/8"	.035
SP-12spb	A	4 1/4"	Polished gold stainless steel	2	2 5/8"	.035
SP-12sab	A	4 1/4"	Antique gold stainless steel	2	2 5/8"	.035
SP-1237	A	4 1/4"	Bone white bonded stainless steel	2	2 5/8"	.035
SP-1238	A	4 1/4"	Black bonded stainless steel	2	2 5/8"	.035
SP-1239	A	4 1/4"	Gray bonded stainless steel	2	2 5/8"	.035
SP-1240	A	4 1/4"	Red bonded stainless steel	2	2 5/8"	.035
SP-12n	B	4 1/4"	Polished Nickeland™	2	2 5/8"	.075/.250
SP-12pb	B	4 1/4"	Polished brass	2	2 5/8"	.075/.250
SP-12ab	B	4 1/4"	Antique brass	2	2 5/8"	.075/.250
<b>4 1/2"</b>						
SP-24	A	4 1/2"	Stainless steel	2	3 3/8"	.035
SP-240	D	4 1/2"	Stainless steel	2	3 3/8"	.035
<b>4 3/4"</b>						
SP-4n	B	4 3/4"	Polished Nickeland™	2	4 3/8"	.150
SP-4pb	B	4 3/4"	Polished brass	2	4 3/8"	.150
SP-4ab	B	4 3/4"	Antique brass	2	4 3/8"	.150
<b>4 7/8"</b>						
SP-3	B	4 7/8"	Stainless steel	2	4 3/8"	.048
SP-6n	C	4 7/8"	Polished Nickeland™	2	4 3/8"	.250
SP-7bs	D	4 7/8"	Scoriated brass	2	4 3/8"	.250
<b>5 1/2"</b>						
SP-8n	B	5 1/2"	Polished Nickeland™	2	4 7/8"	.190
SP-8pb	B	5 1/2"	Polished brass	2	4 7/8"	.190
SP-8ab	B	5 1/2"	Antique brass	2	4 7/8"	.190
SP-8p	C	5 1/2"	Bronze color plastic	2	4 7/8"	.190
SP-9bs	D	5 1/2"	Scoriated brass	2	4 7/8"	.250
SP-9p	D	5 1/2"	Bronze color scoriated plastic	2	4 7/8"	.250
<b>7 1/2"</b>						
SP-10n	B	7 1/2"	Polished Nickeland™	4	6 1/8"	.130
SP-10pb	B	7 1/2"	Polished brass	4	6 1/8"	.130
<b>9 1/2"</b>						
SP-11n	B	9 1/2"	Polished Nickeland™	4	7 3/4"	.150
SP-11pb	B	9 1/2"	Polished brass	4	7 3/4"	.150